

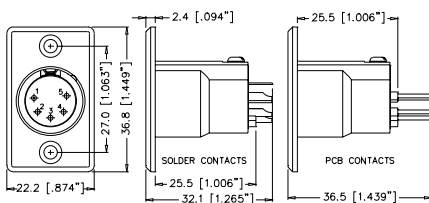

PRODUCT - FIGURE	DRAWING	DESCRIPTION	VARIATIONS	PART NUMBER	
		XLR 4 pole female, Wide flange, Stamped contacts, Nickel Finish	Standard	AC4FPZ	
			Gold Plated Contacts	AC4FPZ- AU	
				Bulk Pack	AC4FPZ BULK
		XLR 4 pole female, Wide flange, Stamped contacts, Black Finish	Standard	AC4FPZB	
			Gold Plated Contacts	AC4FPZB- AU	
				Bulk Pack	AC4FPZB BULK
		XLR 5 pole male, Narrow flange, Machined contacts, Nickel Finish	Standard	AC5MPNZ	
			Gold Plated Contacts	AC5MPNZ- AU	
				Vertical PCB	AC5MPNZV
				Bulk Pack	AC5MPNZ BULK
		XLR 5 pole male, Narrow flange, Machined contacts, Black Finish	Standard	AC5MPNZB	
			Gold Plated Contacts	AC5MPNZB- AU	
				Vertical PCB	AC5MPNZVB
				Bulk Pack	AC5MPNZB BULK
		XLR 5 pole male, Wide flange, Machined contacts, Nickel Finish	Standard	AC5MP	
			Gold Plated Contacts	AC5MP- AU	
				Vertical PCB	AC5MPV
				Bulk Pack	AC5MP BULK
		XLR 5 pole male, Wide flange, Machined contacts, Black Finish	Standard	AC5MPB	
			Gold Plated Contacts	AC5MPB- AU	
				Vertical PCB	AC5MPVB
				Bulk Pack	AC5MPB BULK
		XLR 5 pole female, Wide flange, Machined contacts, Nickel Finish	Standard	AC5FPZ	
			Gold Plated Contacts	AC5FPZ- AU	
				Vertical PCB	AC5FPZV
				Bulk Pack	AC5FPZ BULK
		XLR 5 pole female, Wide flange, Machined contacts, Black Finish	Standard	AC5FPZB	
			Gold Plated Contacts	AC5FPZB- AU	
				Vertical PCB	AC5FPZVB
				Bulk Pack	AC5FPZB BULK



## STANDARD DATA AC SERIES CHASSIS - METAL “Z”

		VALUE				
<b>GENERAL CHARACTERISTICS</b>	Number of contacts	3	4	5	6A	7
	Contact Arrangement (Front view of pin inserts)					
	Termination	Solder Bucket / Printed Circuit Board (PCB)				
	Max. Wire Gauge - Stranded wire: Solder Printed Circuit Board - PCB	14AWG N/A	16AWG N/A	18AWG N/A	18AWG N/A	20AWG N/A
Flammability rating of plastics	UL94V-0					
<b>ELECTRICAL CHARACTERISTICS</b>	Service Voltage RMS	133V <sup>1)</sup>				
	Test Voltage AC RMS	1400V				
	Current carrying capacity: Solder Printed Circuit Board (PCB)	15A 15A	10A 10A	7.5A 7.5A	7.5A 7.5A	5A 5A
	Typical Contact Resistance	≤ 3mΩ				
	Insulation Resistance	≥ 1000MΩ				
<b>CLIMATIC CHARACTERISTICS</b>	Protection Class	IP40				
	Operating Temperature	-25 °C to +75 °C				
<b>MECHANICAL CHARACTERISTICS</b>	Weight - Metal <sup>2)</sup>	31g (0.068lb)	32g (0.070lb)	33g (0.072lb)	33g (0.072lb)	33g (0.072lb)
	Mechanical Operations	1000 mating cycles				
<b>MATERIALS</b>	Connector Shell	Diecast Zinc Alloy				
	Shell Finish	Satin Nickel or Black Polyester				
	Insulators	UL94V-0 PBT Resin or Modified PPE Resin				
	Male Contact					
	Stamped Solder and PCB-(Material/Plating)	Phosphor Bronze / Silver or Gold (optional)				
	Machined Solder-(Material/Plating)	Brass / Silver or Gold (optional)				
Female Contact	Stamped Solder and PCB-(Material/Plating)	Phosphor Bronze / Tin or Gold (optional)				
	Machined Solder-(Material/Plating)	Brass / Silver or Gold (optional)				

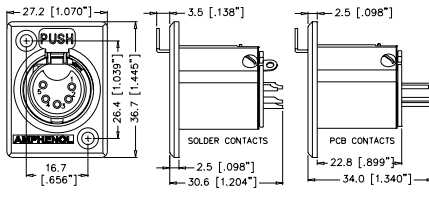
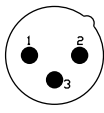
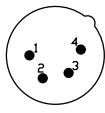
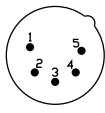
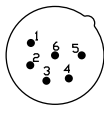
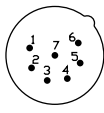
<sup>1)</sup> Not suitable for domestic applications above 50V

<sup>2)</sup> Approximate weight only, does not include packaging. Please contact us for exact weight for shipping purposes.

## AC SERIES CHASSIS METAL "Z"

### PCB FOOTPRINTS STRAIGHT (V)

- CONNECTOR SIDE OF PCB

### PANEL CUTOUT DIMENSIONS

-FRONT VIEW



AC3F\*ZV

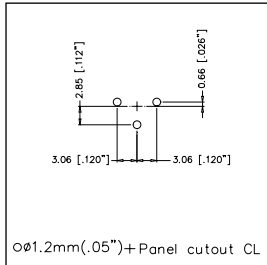

AC3M\*ZV

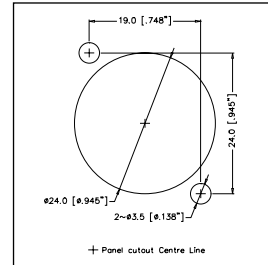
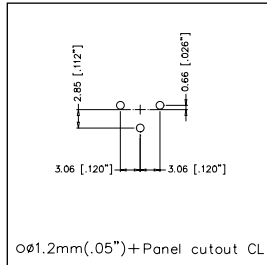

AC\*FDZ

AC3MM\*ZV

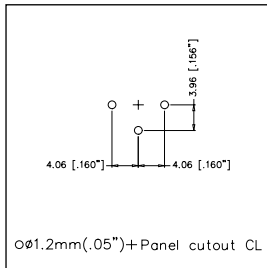

AC4M\*ZV

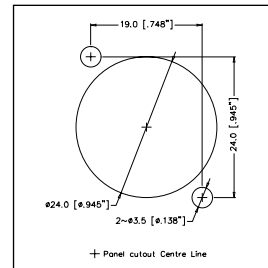
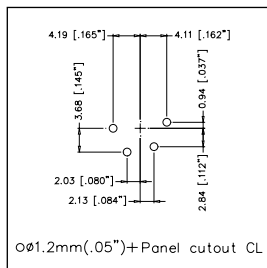

AC\*MDZ

AC5F\*ZV

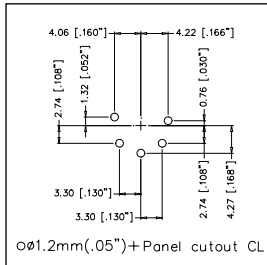

AC5M\*ZV

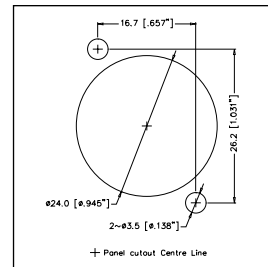
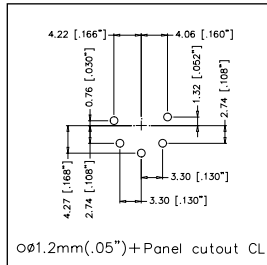

AC\*FPZ  
AC-PDN-31-XXX

AC6AF\*ZV

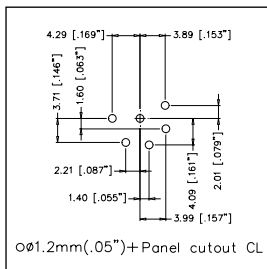

AC6AM\*ZV

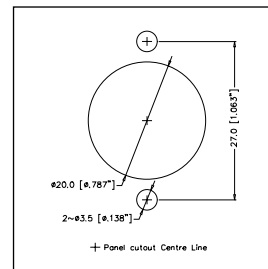
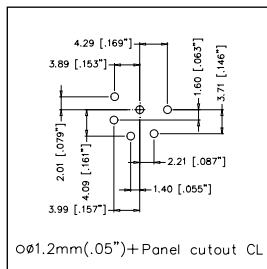

AC\*MPNZ

AC7F\*ZV

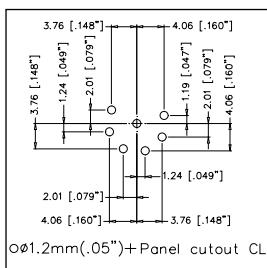

AC7M\*ZV

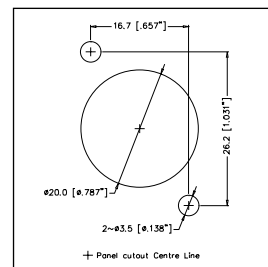
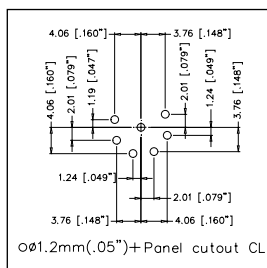

AC\*MP  
AC-PDN-34-XXX