

PRODUCT - FIGURE	DRAWING	DESCRIPTION	VARIATIONS	PART NUMBER
		XLR 3 pole male, Wide flange, Stamped contacts, Nickel Finish	Standard	AC3MP
			Gold Plated Contacts	AC3MP-AU
			Vertical PCB	AC3MPV
			Bulk Pack	AC3MP BULK
		XLR 3 pole male, Wide flange, Stamped contacts, Black Finish	Standard	AC3MPB
			Gold Plated Contacts	AC3MPB-AU
			Vertical PCB	AC3MPVB
			Bulk Pack	AC3MPB BULK
		XLR 3 pole female, Wide flange, Stamped contacts, Nickel Finish	Standard	AC3FPZ
			Gold Plated Contacts	AC3FPZ-AU
			Vertical PCB	AC3FPZV
			Bulk Pack	AC3FPZ BULK
		XLR 3 pole female, Wide flange, Stamped contacts, Black Finish	Standard	AC3FPZB
			Gold Plated Contacts	AC3FPZB-AU
			Vertical PCB	AC3FPZVB
			Bulk Pack	AC3FPZB BULK
		XLR 4 pole male, Narrow flange, Machined contacts, Nickel Finish	Standard	AC4MPNZ
			Gold Plated Contacts	AC4MPNZ-AU
			Vertical PCB	AC4MPNZV
			Bulk Pack	AC4MPNZ BULK
		XLR 4 pole male, Narrow flange, Machined contacts, Black Finish	Standard	AC4MPNZB
			Gold Plated Contacts	AC4MPNZB-AU
			Vertical PCB	AC4MPNZVB
			Bulk Pack	AC4MPNZB BULK
		XLR 4 pole male, Wide flange, Machined contacts, Nickel Finish	Standard	AC4MP
			Gold Plated Contacts	AC4MP-AU
			Vertical PCB	AC4MPV
			Bulk Pack	AC4MP BULK
		XLR 4 pole male, Wide flange, Machined contacts, Black Finish	Standard	AC4MPB
			Gold Plated Contacts	AC4MPB-AU
			Vertical PCB	AC4MPVB
			Bulk Pack	AC4MPB BULK

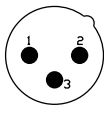
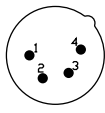
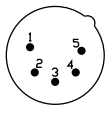
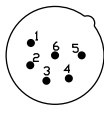
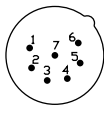

STANDARD DATA AC SERIES CHASSIS - METAL “Z”

		VALUE				
GENERAL CHARACTERISTICS	Number of contacts	3	4	5	6A	7
	Contact Arrangement (Front view of pin inserts)					
	Termination	Solder Bucket / Printed Circuit Board (PCB)				
	Max. Wire Gauge - Stranded wire: Solder Printed Circuit Board - PCB	14AWG N/A	16AWG N/A	18AWG N/A	18AWG N/A	20AWG N/A
Flammability rating of plastics	UL94V-0					
ELECTRICAL CHARACTERISTICS	Service Voltage RMS	133V ¹⁾				
	Test Voltage AC RMS	1400V				
	Current carrying capacity: Solder Printed Circuit Board (PCB)	15A 15A	10A 10A	7.5A 7.5A	7.5A 7.5A	5A 5A
	Typical Contact Resistance	≤ 3mΩ				
	Insulation Resistance	≥ 1000MΩ				
CLIMATIC CHARACTERISTICS	Protection Class	IP40				
	Operating Temperature	-25 °C to +75 °C				
MECHANICAL CHARACTERISTICS	Weight - Metal ²⁾	31g (0.068lb)	32g (0.070lb)	33g (0.072lb)	33g (0.072lb)	33g (0.072lb)
	Mechanical Operations	1000 mating cycles				
MATERIALS	Connector Shell	Diecast Zinc Alloy				
	Shell Finish	Satin Nickel or Black Polyester				
	Insulators	UL94V-0 PBT Resin or Modified PPE Resin				
	Male Contact					
	Stamped Solder and PCB-(Material/Plating)	Phosphor Bronze / Silver or Gold (optional)				
	Machined Solder-(Material/Plating)	Brass / Silver or Gold (optional)				
Female Contact	Stamped Solder and PCB-(Material/Plating)	Phosphor Bronze / Tin or Gold (optional)				
	Machined Solder-(Material/Plating)	Brass / Silver or Gold (optional)				

¹⁾ Not suitable for domestic applications above 50V

²⁾ Approximate weight only, does not include packaging. Please contact us for exact weight for shipping purposes.

AC SERIES CHASSIS METAL "Z"

PCB FOOTPRINTS STRAIGHT (V)

- CONNECTOR SIDE OF PCB

PANEL CUTOUT DIMENSIONS

-FRONT VIEW



AC3F*ZV

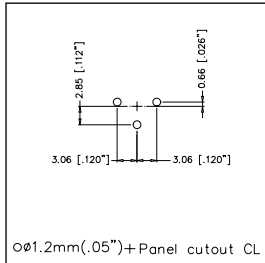

AC3M*ZV

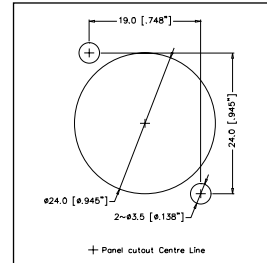
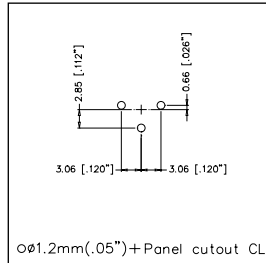

AC*FDZ

AC3MM*ZV

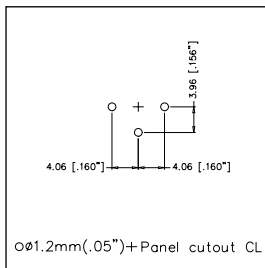

AC4M*ZV

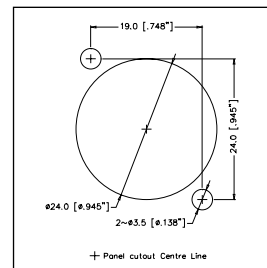
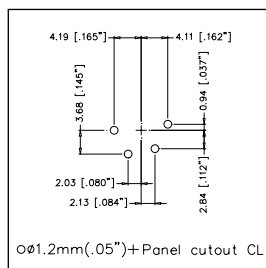

AC*MDZ

AC5F*ZV

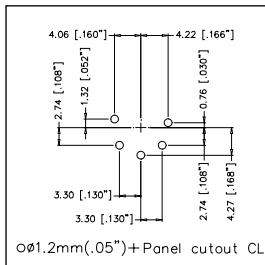

AC5M*ZV

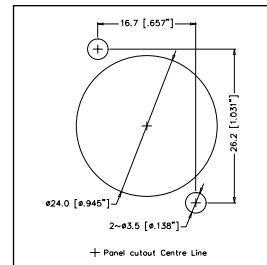
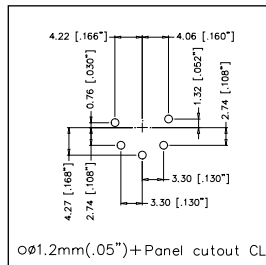

AC*FPZ
AC-PDN-31-XXX

AC6AF*ZV

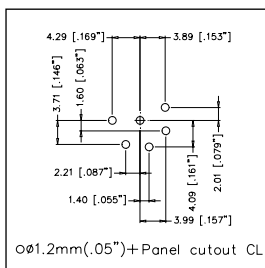

AC6AM*ZV

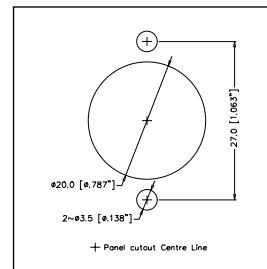
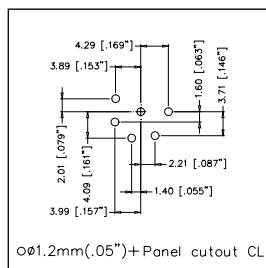

AC*MPNZ

AC7F*ZV

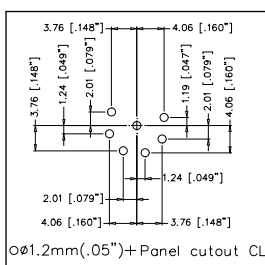

AC7M*ZV

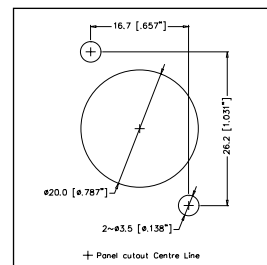
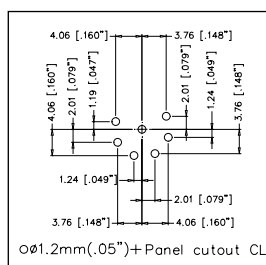

AC*MP
AC-PDN-34-XXX